

Shorty Cylinders

- Capacity: 10 - 200 tons.
- Stroke: 44 - 50mm.
- Maximum Pressure: 700 Bar
- Hydraulic Coupler: TBC 381F(PT3/8)
- Compact, flat design for use where other cylinders will not fit.

Understanding the Model No: TSSC-1044

- **T** - TECPOS
- **SSC** - Shorty cylinder
- **10** - Capacity, 10ton
- **44** - Stroke, 44mm

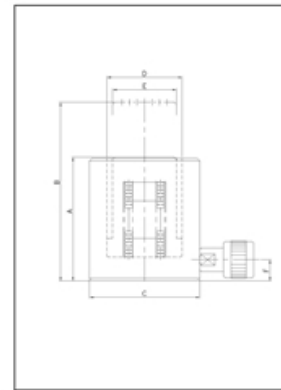

Dimensions

Model	Cyl. Cap. (tons)	Stroke (mm)	Cyl. Effective Area (cm ²)	Oil Cap. (cc)	Retracted Height A	Extended Height B	Cyl. Out Dia. C	Cyl. Bore Dia. D	Piston Rod Dia. E	Base to inlet port H	Weight (kgs)	Pump
TSSC-1044	10	44	15.2	66	99	143	68	44	38	17	2.6	1B
TSSC-2044	20	44	28.3	124	99	143	88	60	51	17	4.3	
TSSC-3044	30	44	44.2	194	99	143	105	75	64	17	6.2	
TSSC-5050	50	50	63.6	318	109	159	125	90	75	19	10.2	
TSSC-10050	100	50	132.7	663	139	189	165	130	100	27	21	1C
TSSC-15050	150	50	201	1005	170	220	208	160	135	33	41.1	
TSSC-20050	200	50	283.5	1417	180	230	245	190	170	38	60.3	